

Sound Absorption Prediction 2.8

Program copyright Marshall Day Acoustics 2006

Margin of error is generally within +/- 0.05

JobName:Resident

Job No.:50+100m

Date: 6 XII 09

Initials:OBIFON s.r.o

File name:

Notes:

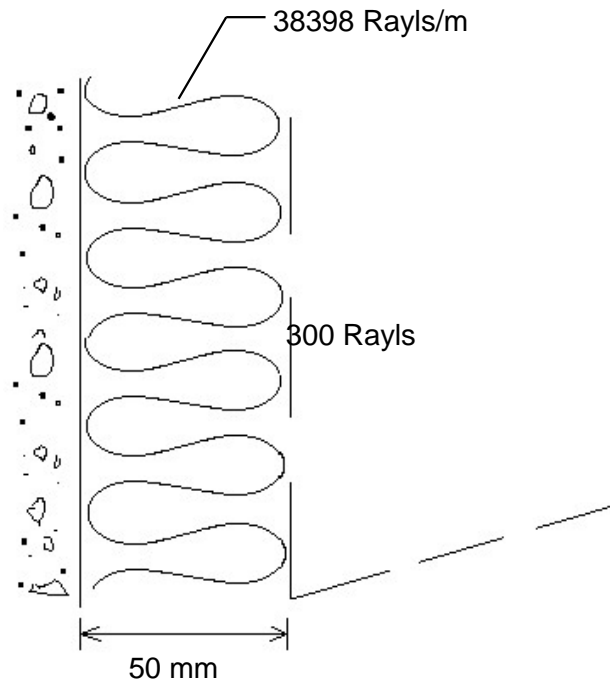

$$\alpha_w : 0,90$$

Frequency (Hz)	alpha random	
50	0,04	
63	0,06	
80	0,10	
100	0,15	
125	0,23	0,25
160	0,35	
200	0,50	
250	0,65	0,65
315	0,77	
400	0,90	
500	0,92	0,90
630	0,93	
800	0,97	
1000	0,95	0,95
1250	0,93	
1600	0,94	
2000	0,93	0,95
2500	0,93	
3150	0,93	
4000	0,94	0,95
5000	0,94	

