

Sound Absorption Prediction 2.8

Program copyright Marshall Day Acoustics 2006

Margin of error is generally within +/- 0.05

JobName:Modular

Job No.:50mm

Date: 6 XII 09

Initials:OBIFON s.r.o

File name:

Notes:

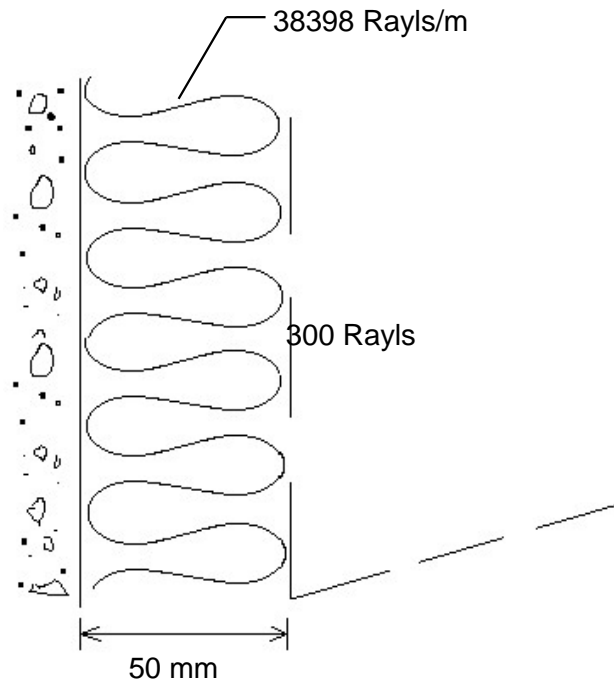

$$\alpha_w : 0,90$$

Frequency (Hz)	alpha random	
50	0,04	
63	0,06	
80	0,10	
100	0,15	
125	0,23	0,25
160	0,35	
200	0,50	
250	0,65	0,65
315	0,77	
400	0,90	
500	0,92	0,90
630	0,93	
800	0,97	
1000	0,95	0,95
1250	0,93	
1600	0,94	
2000	0,93	0,95
2500	0,93	
3150	0,93	
4000	0,94	0,95
5000	0,94	

